



## 3620-300 Electromechanical Deadlocking Bolt



# RR Brink

For More information please call 210-123-4567



# Electric Locks

## 3620-300 Electromechanical Deadlocking Bolt



### APPLICATION

- The 3620-300 is ideal for access control in secure areas of commercial, institutional, governmental, and industrial buildings.
- The 24VDC gearmotor achieves remote unlocking even when an abnormally high 300 pound side force is applied against the latch.
- Available functions allow for electrical latch retraction and extension from a remote control point as well as manual key unlocking at the door.
- Standard with RRBLS 2" diameter detention grade Mogul cylinder. Workable with 2" diameter builders' hardware brands. See "Key Cylinders" catalog page for elaboration.
- This lock is commonly used in medium security correctional facilities to provide remotely controlled electric unlocking of detention area sleeping room and exit doors.

(Note: Not recommended for maximum security detention applications.)

### STANDARD FEATURES

- Structural and locking parts are stainless steel
- All other parts and fasteners of copper alloy or stainless steel
- A full 3/4" throw cast stainless steel latch with two (2) saw resistant inserts.
- Standard with RRBLS 2" diameter detention grade Mogul cylinder. Workable with 2" diameter builders' hardware brands. See "Key Cylinders" catalog page for elaboration.
- Maintained Switch Latch Holdback (MSLH) function (see "Motor Lock Function Reference Guide" for other functions).
- Lock status switch (LSS) trips when latch is in deadlocked condition. Used in a signal circuit to indicate lock status – unlocked or deadlocked – via control panel lights and/or alarm devices. The LSS is also used to control an electrical interlock, which permits only one of a group of doors to be unlocked at any time. Note: For positive, tamper resistant signaling of a closed and deadlocked door, a sensitive door position (DPS) switch must be wired in combination with the LSS. Our DPS Models 201030 or 201090 are recommended.
- For stop (push) side frame keying see optional "key cylinder extension" (KCE).
- Plug connectors are provided for ease in wiring and removal.
- Exposed fasteners – pinned "Torx" head
- Exposed Faceplate
- Satin Stainless Steel – (ANSI 630, US32D)



For More information please call 210-123-4567

# Electric Locks

## 3620-300 Electromechanical Deadlocking Latch

### OPTIONAL FEATURES

- KCE – Stop (push) side key cylinder extension extends working length of a standard or mogul mortise key cylinder to adapt to jamb depths within a range of 4" to 9" (advise jamb depth dimension). Customer supplied cylinders must be factory fitted to each KCE.
- CKS – Factory key cylinder modification and an internal limit switch produce a key switch feature which electrically actuates the lock by one way only rotation of the change level key. This feature can be rendered inoperative by switch from a remote control panel. Mechanical unlocking is by a master level key. This feature is indicated when it is desirable to restrict periods when key unlocking is possible, e.g. building access or prison inmates who carry a key to their cell.
- RC – Rectifier with plug-in adapter permits 24V A C input

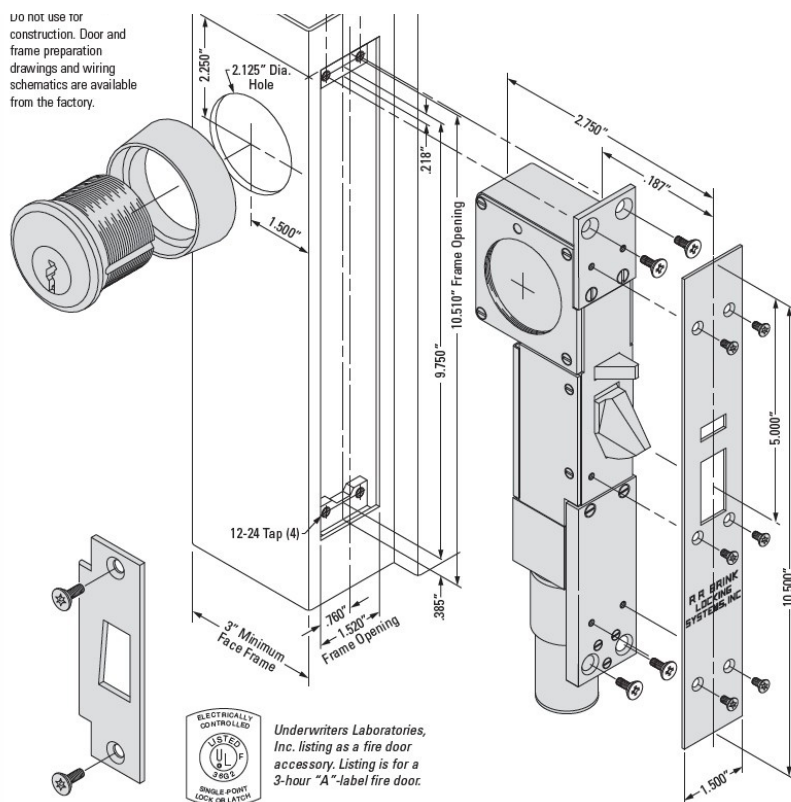

### ELECTRICAL DATA

Motor	24VDC, 1.0 amp or 120VAC, 3 amp
Lock Status Switch	SPDT type, UL listed, 125/250 VAC, 5 amp.

Model	Description
7052M	7050M keyed one side
7056M	7050M keyed both sides

For More information please call 210-123-4567

