

# 17-M Latch



# Folger Adam



For More information please call 210-533-1231

# Mechanical Locks

## 17-M Latch



### Accessories

(must be purchased separately)

- 17-4F – Keeper/pull for surface mounted lock.
- 17-4FPD – Food pass door with 17-4 keeper/pull (specify 3FP hinges separately).

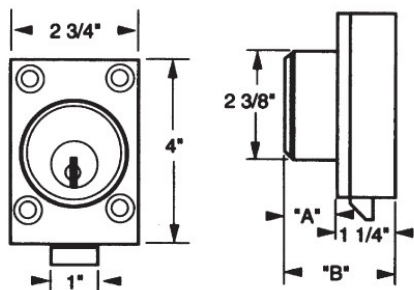

Note: Dimensions are for information and planning purposes only, and should not be used as templates.

17-M0 110 Mogul cylinder - keyed cover side  
17-M1 190 Maxi-Mogul® - keyed cover side

### Applications

Ideal for food-pass doors, small wicket doors or observation panels. 17-M0 and 17-M1 latches are designed to mount above the door and snap-lock instantly on closure. These latches are specified with either the 110 Mogul, or exclusive 190 Maxi-Mogul® cylinder as needed. When Maxi-Mogul® cylinders are specified, level 1 keying will be provided.

### Standard Features

- Maxi-Mogul® key cylinder – Provides maximum pick resistance. UL437 listed.
- Case – Ductile iron.
- Corrosion-resistant – Working parts are corrosion-resistant.
- Latchbolt throw – 7/16". Flush when retracted, or 1/2" projection for hollow metal pocket installation.
- Large, solid latchbolt – Investmentcast stainless steel, 1" x 7/16".
- Security screws – Supplied with four 1/4-20 x 1-1/2" flat head security screws.
- Finish – Zinc plated.

### Optional Features

- Square bolt – Flush and 1/2" projection stainless steel square bolt for special applications.
- 110 Mogul key cylinder – For existing applications.
- Cylinder finish – US26D
- Hollow metal mounting – Combined with 1/2" bolt projection for in-the-door pocket mounting.
- Keying – Master keying is available.

Demension	Maxi-Mogul	Mogul
A	1-3/8"	1-1/8"
B	2-5/8"	2-3/8"

For More information please call 210-533-1231

